

cooking collection

Instructions for use and warranty details

Rangehood – 40cm
Model No.: RHWMDB40

 **kLEENmaid**

Congratulations on the purchase of your new Kleenmaid appliance.

Your new Kleenmaid appliance has been designed and manufactured to give you years of reliable performance.

For best results, carefully read the instructions on how to install your new appliance. Correct installation will avoid delays and unnecessary service call costs.

Once installation is complete, please read this entire instruction manual carefully and get to know the controls and the features of your new Kleenmaid appliance.

Again, congratulations and thank you for choosing Kleenmaid.



A

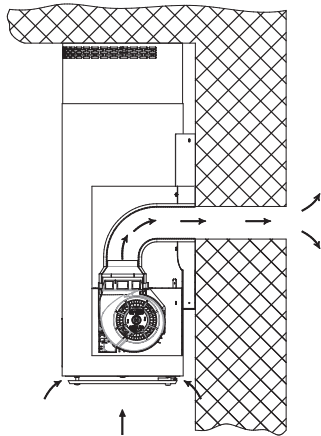

1X



2X



X = $\begin{cases} 1 \times \varnothing 150 \\ \text{O} \\ 1 \times \varnothing 120 \end{cases}$

B

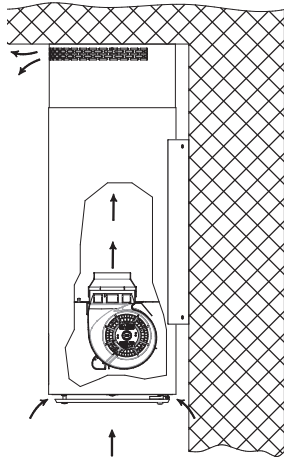

2 X

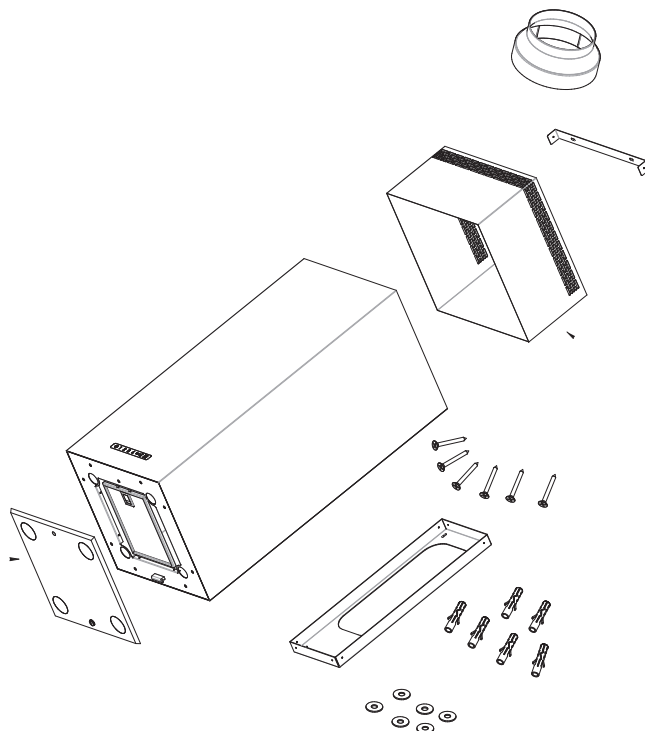
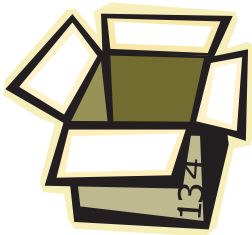

Dear Customer,

We would like to thank you and congratulate you on your choice.

This new product has been carefully designed and built using top quality materials, and meticulously tested to ensure that it meets all your culinary requirements.

Please read and observe these simple instructions, which will enable you to achieve excellent results from the very first time you use it. This state-of-the-art appliance comes to you with our very best wishes.

THE MANUFACTURER

THIS PRODUCT IS DESIGNED FOR DOMESTIC USE.

THE MANUFACTURER DECLINES ALL RESPONSIBILITY FOR DAMAGES TO THINGS OR PEOPLE DERIVING FROM INCORRECT INSTALLATION OR IMPROPER, ERRONEOUS OR UNSUITABLE USE.

THE APPLIANCE MUST NOT BE USED BY PEOPLE (INCLUDING CHILDREN) WITH PHYSICAL, SENSORIAL OR MENTAL IMPAIRMENTS, OR BY PEOPLE WITHOUT THE NECESSARY EXPERIENCE OR KNOWLEDGE, UNLESS THEY ARE

SUPERVISED OR INSTRUCTED IN THE USE OF THE APPLIANCE BY A PERSON RESPONSIBLE FOR THEIR SAFETY.

CHILDREN MUST BE SUPERVISED TO ENSURE THAT THEY DO NOT PLAY WITH THE APPLIANCE.

We recommend that you wear gloves during installation and maintenance.

When installing a vented version (the extracted air is sent outside = Fig. A), it is important to:

- prepare an air exhaust hole and duct with a diameter of 150 mm.
- use a duct that is as short as possible
- use a duct with the least number of curves possible (maximum curve angle 90°)
- avoid the use of flat ducts and ducts of different section as much as possible
- use a duct with the smoothest possible interior and conforming to the standard
- do not connect the rangehood to a duct that exhausts fumes produced by combustion (fireplaces, boilers, ovens, etc.)
- do not discharge the air into a cavity in the wall unless the cavity has been prepared for that purpose.
- provide the room with air intakes so that the hood does not create negative suction (no higher than 0.04 mbar).

When installing a recirculating version (the extracted air is returned to the kitchen = Fig. B) there is no need to prepare a hole and exhaust duct, but you must provide two activated carbon filters (request them separately as an accessory).

Fig. 1: using the fixing bracket (1), mark the positions of the fastening holes on the ceiling.

Fasten using no. 2 anchors $\varnothing 8$ + no. 2 screws $\varnothing 4.8 \times 38$ + no. 2 washers.

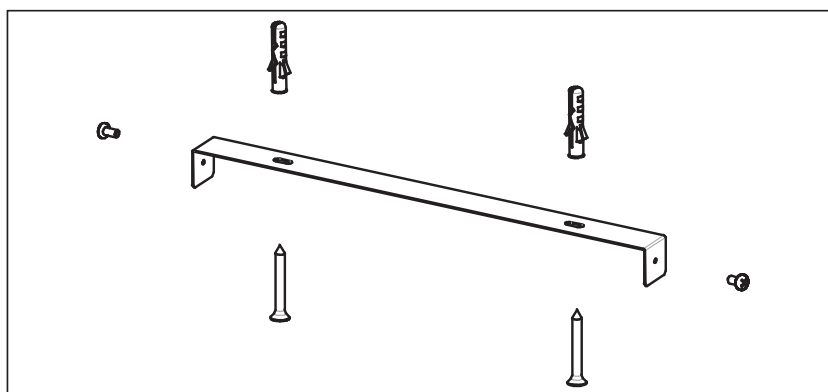

Fig. 2: attach the cover with grill (2) to the fixing bracket (1). (If you wish this cover can be omitted in the vented version).

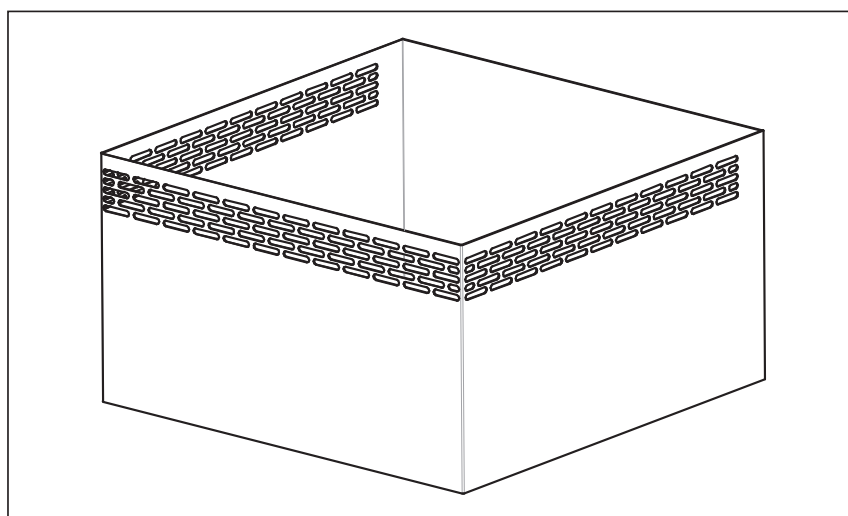
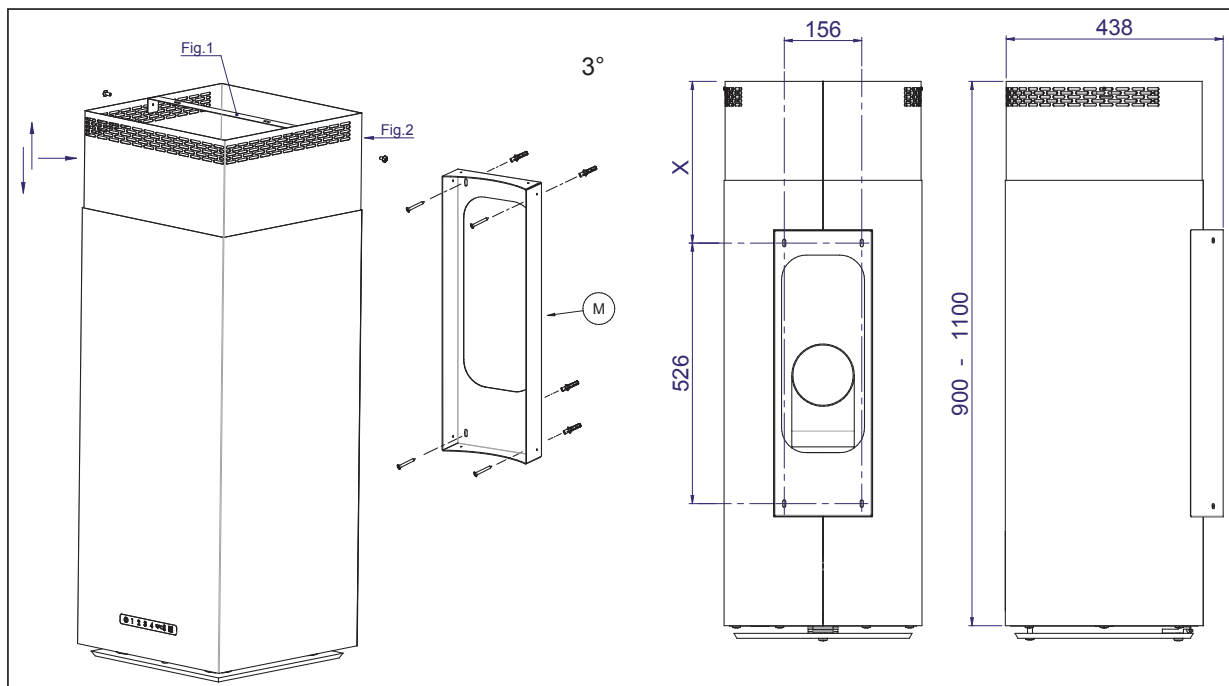

Fig. 3: adjust the telescopic section of the upper cylinder and fasten it to the bracket (1) using the two M4X12 screws provided.



IMPORTANT: to fasten the rangehood to the bracket that has previously been fastened to the wall, see detail (M); if you need to know the height at which the rangehood must be positioned, see the measurements table.

X = 327 H = 1100
X = 227 H = 1000

The H900 does not need part 2
Variable rangehood height: 900 - 1000 - 1100

Fig. 4: mount the grease filter on the rangehood cylinder with the metal handle.

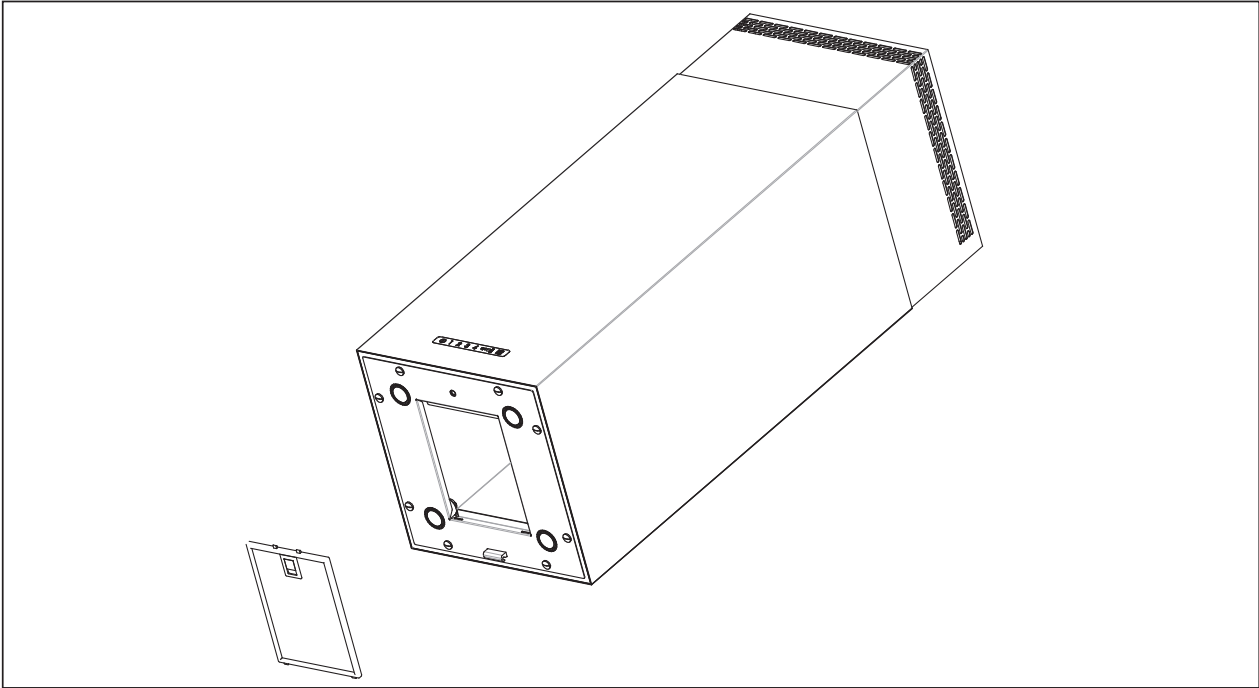

Fig. 5: position the glass with the smaller diameter facing down (A).

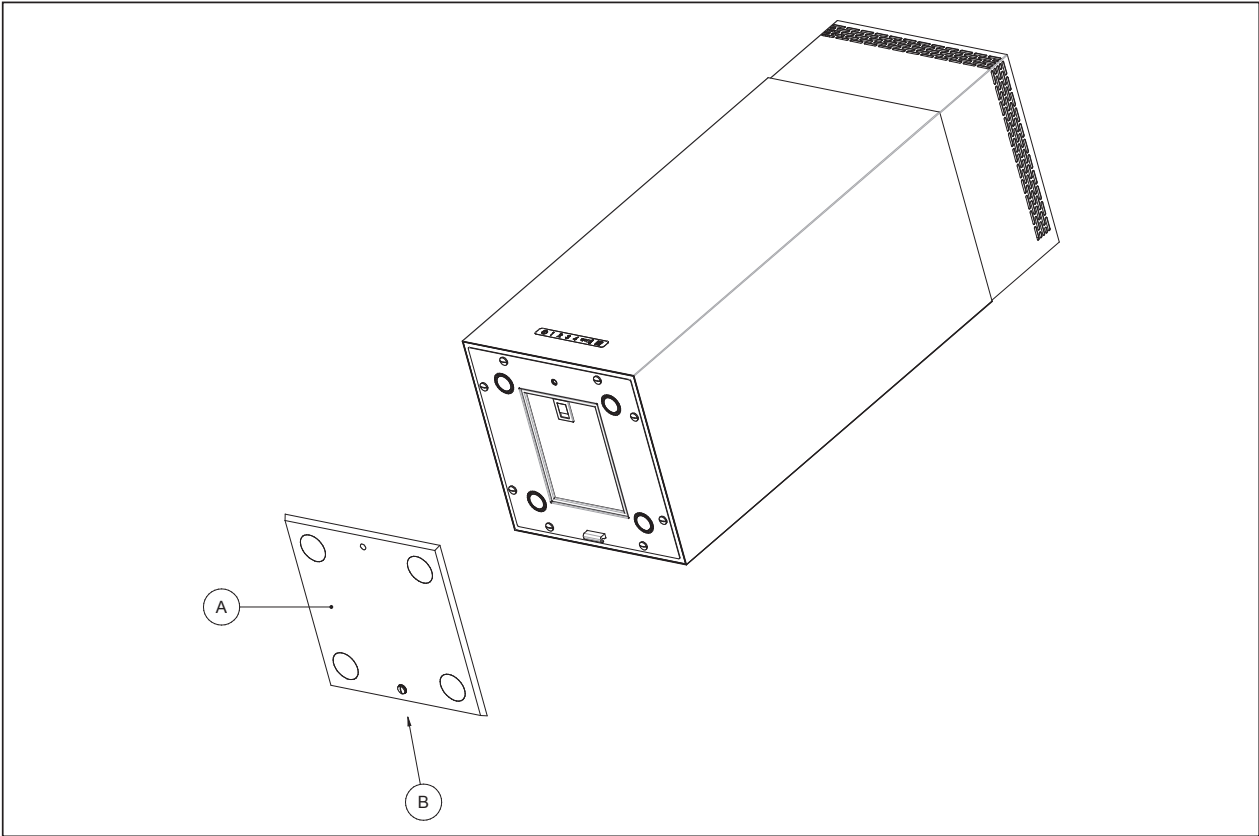

Fig. 6: hook the hinge (B) integrated into the glass to the hook of the male hinge C.

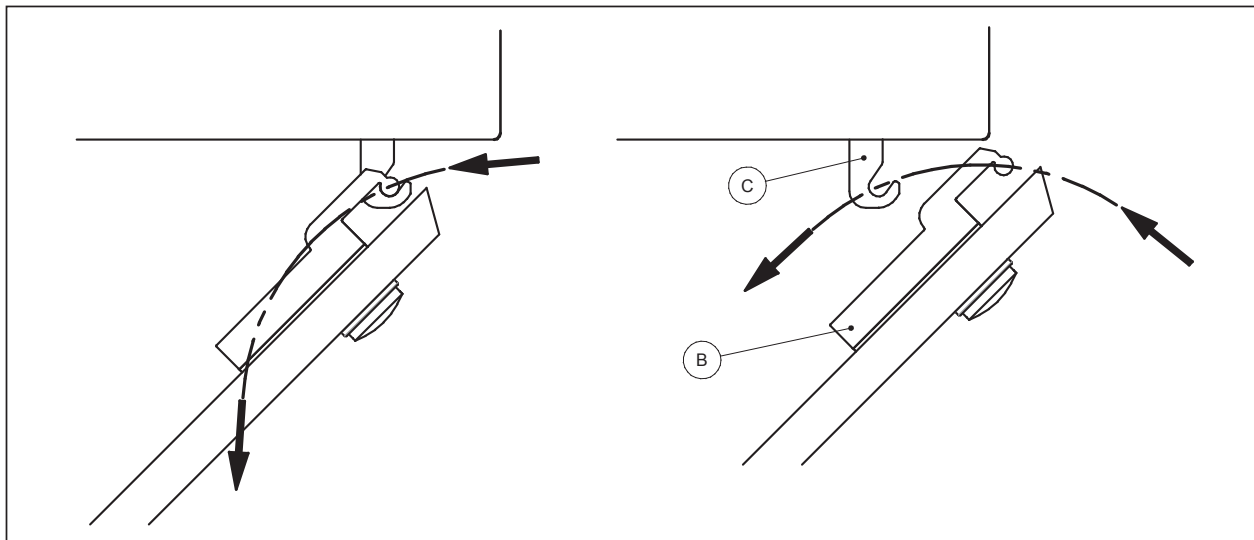

Fig. 7: slide the H26 Nylon spacer on the M6X40 screw provided and fasten it, by passing through the hole in the hole in the glass, to the upper hole in the rangehood cylinder, tightening it by hand or using a tool or coin.

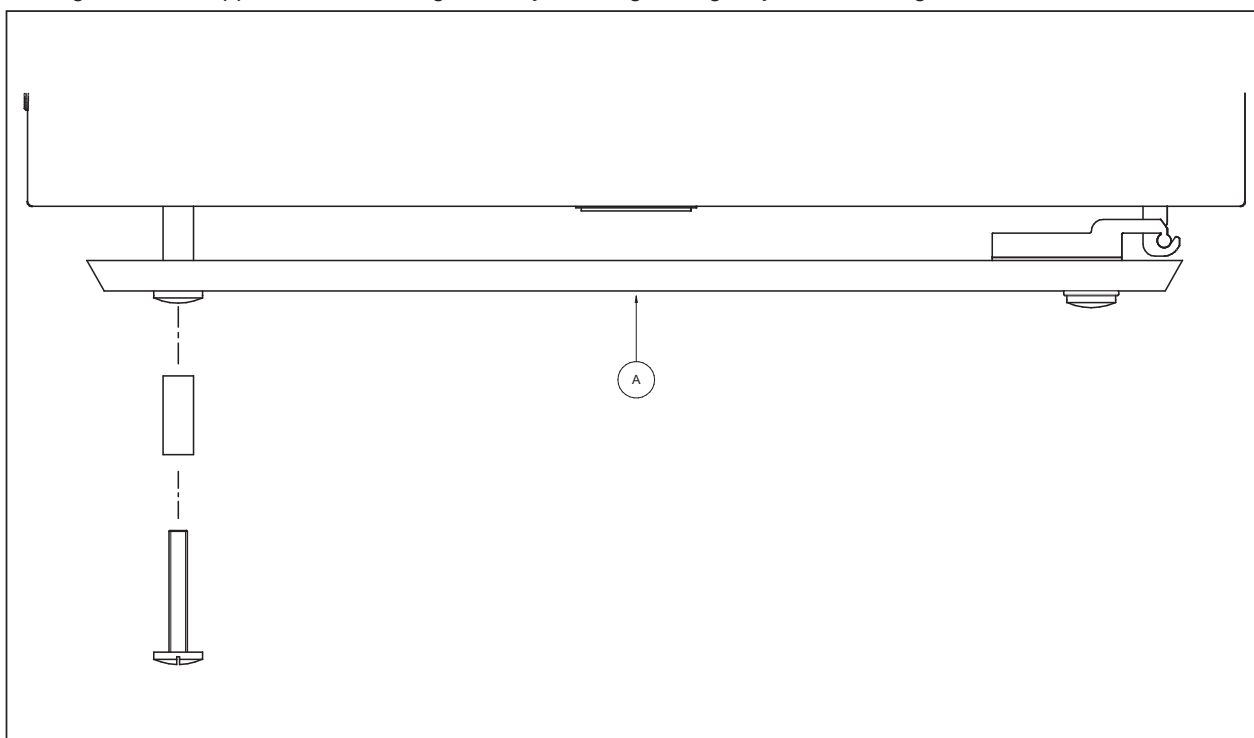
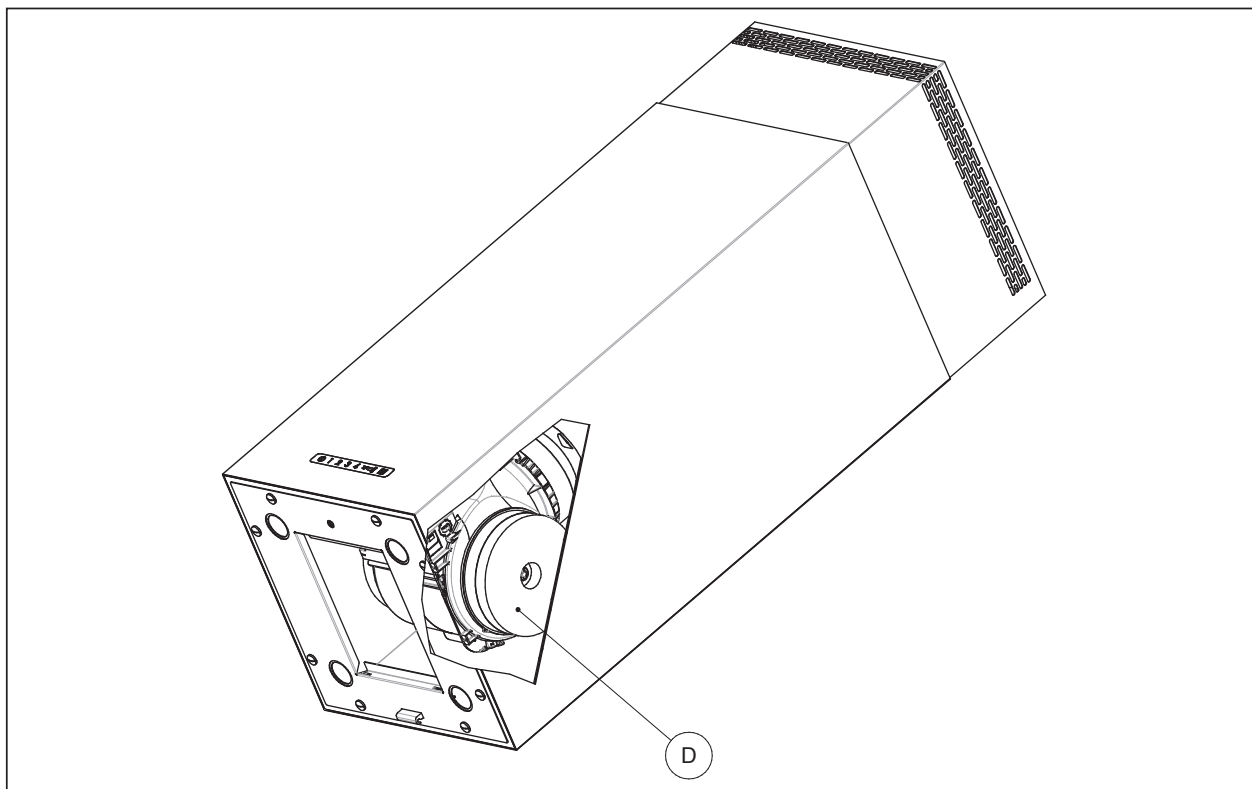
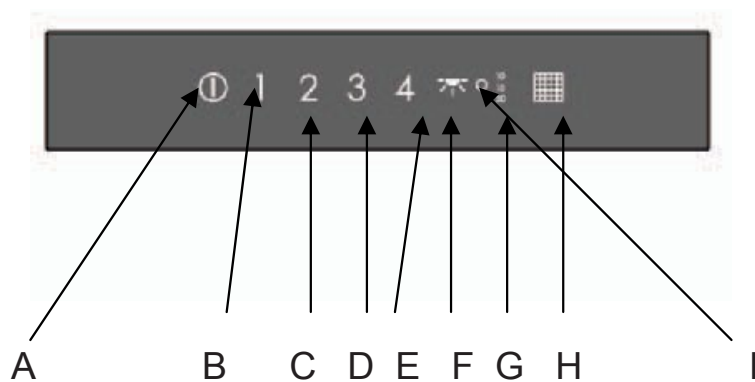

Fig. 8: if a recirculating rangehood is being installed, you must request two carbon filters (D) (supplied as a separate accessory). Proceed to the insertion of the drawer-type carbon filter with the required type of slot system.



CONTROLS



- A) starts/stops the motor at the second speed (the intermediate operating speed)
- B) selects the first motor speed
- C) selects the second motor speed
- D) selects the third motor speed
- E) selects the fourth motor speed
- F) turns on the halogen lamp: if held down, you can select 3 different levels of light. The last level selected is remembered for the next time it is turned on.
- G) turns on the timer (delayed turn-off): you can choose from 3 times (10', 15', 20')
- H) *Filter alarm (see detail)
- I) remote-control receiver sensor

***Filter alarm:**

The first thing to do after inserting the plug is to set the rangehood to vented or recirculating mode; proceed as follows: when the plug is inserted, all the lights turn on for several seconds: in this state, press the on/off button for about 8 seconds until the H LED lights. Then press B if you want the rangehood to operate in vented mode (in this mode, the carbon filter count is not working because there is no filter); the red LED of the H filter light flashes and you confirm the selection by pressing it. To set the rangehood to recirculating mode (and, thus, with counts for both the grease filters and the carbon filters), about 8 seconds after turning it on, press C and the red light of the H filter hood will turn steady on; press it to confirm. After 30 hours of operation, the H button will turn steady on: this means that it is time to remove and clean the grease filters. If the rangehood is in recirculating mode, after 140 hours of operation, the H button will flash: this means that it is time to replace the carbon filters. To reset the count, press the H button for 7-8 seconds. The filter hour count cannot be reset until the system turns on one of the alarms. So it is not possible to perform intermediate resets.

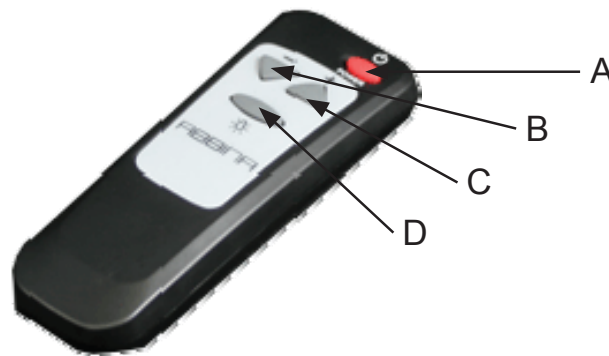
**OPERATION OF THE REMOTE CONTROL
(if provided)**

- A) Turns the rangehood on/off at the second speed
- B) Decreases the speed of the motor
- C) Increases the speed of the motor
- D) Turns the lights on/off. (The intensity can only be regulated manually directly on the rangehood)

MAINTENANCE

Turn off the electricity before performing any maintenance or cleaning!

Cleaning the rangehood:

Clean the rangehood at least once every 2 months to avoid the risk of fire; to clean the external body, use a cloth wet with warm water and a neutral detergent, or products specifically made for stainless steel. To clean inside the rangehood, use a cloth wet with denatured alcohol.

Do not use abrasive or corrosive products!

Cleaning the grease filters (on both the vented and recirculating rangehood versions)

Clean the grease filters at least once every 2 months to avoid the risk of fire (however, the frequency of cleaning depends on how intensely you use the rangehood).

To remove the grease filter, use the handle on the filter.

Wash with neutral detergent by hand or in the dishwasher. Keep in mind that washing in the dishwasher could discolour/ darken the filters without, however, reducing their effectiveness.

Replacing the carbon filters (recirculating version only):

Replace the activated carbon filters at least once every 6 months to avoid the risk of fire (however, the frequency of cleaning depends on the intensity with which you use the rangehood).

Replacement of bulbs:



Delicately remove the glass bulb cover with a screwdriver.

Replace the bulb with the same type, taking care not to touch the new bulb with your bare hands to void damaging it.
Do not touch the bulb if it is still hot!

OPERATING PROBLEMS

Before calling for service, check these simple things:

Why is the rangehood not working?

- has the electricity been interrupted?
- was the rangehood on?
- is the power plug disconnected and/or damaged?

Why is the rangehood working poorly?

- was the rangehood turned on at a sufficient speed to extract the fumes and vapours generated?
- is the kitchen sufficiently ventilated to allow for good air intake?
- do the grease filters need to be cleaned?
- do the carbon filters need to be replaced (in the case of a recirculating rangehood)?
- after 10 minutes of uninterrupted operation at the fourth speed, the rangehood automatically goes to the second speed unless a timer was activated (energy savings).

Why did the rangehood suddenly turn off?

- was there a sudden interruption of the electricity?
- is the power plug disconnected and/or damaged?
- after 5 hours of uninterrupted operation, the rangehood automatically turns off (energy savings)

KLEENMAID WARRANTY TERMS AND CONDITIONS

1. Compass Capital Services Pty Ltd ABN 96 138 214 525 trading as Kleenmaid will provide parts and labour to you the customer as set out herein.
2. Kleenmaid's Products come with guarantees that cannot be excluded under the Australian Consumer Law. You are entitled to a replacement or refund for a major failure and for compensation for any other reasonably foreseeable loss or damage. You are also entitled to have the goods repaired or replaced if the goods fail to be of acceptable quality and the failure does not amount to a major failure.
3. The benefits given to you under this Kleenmaid Warranty are in addition to other rights and remedies to which you may be entitled under the Australian Consumer Law in relation to the Product to which this Kleenmaid Warranty relates. Subject to the conditions below, the Product is warranted by Kleenmaid and/or its agents to be free from defects in materials and workmanship for the Warranty Period for normal Domestic Use.
4. Product Identification: -
 - a. Kleenmaid reserves the right to reject claims for any services or work where you cannot produce for verification the serial number and a proof of purchase for the Product (including but not limited to the original invoice).
 - b. This Kleenmaid Warranty will be voided if the serial number for the Product cannot be verified. This is not intended to exclude, restrict or modify any right or remedy to which you may otherwise be entitled under the consumer guarantee provisions of the Australian Consumer Law.
 - c. In the event that a request for repair is made against this Kleenmaid Warranty where the serial number for the Product cannot be verified or you cannot produce for verification a proof of purchase for the Product (including but not limited to the original invoice), the repairer will not carry out any repairs on the Product and you will be charged a service call-out fee.
5. What is covered by this Kleenmaid Warranty: -
 - a. The Product is covered for faulty workmanship or parts that have failed under normal Domestic Use.
 - b. Kleenmaid and/or its agents will determine by objective testing if there are any defects in the Product and/or faulty workmanship.
 - c. This Kleenmaid Warranty is only applicable if repairs on Products are carried out within Mainland Australia.
 - d. This Kleenmaid Warranty: -
 - i. covers a Product purchased as new, manufactured for use in Mainland Australia;
 - ii. commences from the date of delivery of the Product;
 - iii. provides for the labour and replacement parts necessary to maintain the Product in good operating condition as specified in this Kleenmaid Warranty, however, if repair is needed because of Product failure during normal Domestic Use, Kleenmaid has the option to repair or replace the defective Product or part of the Product with a product or part of like kind and quality. A replacement part may be new or reconditioned of like kind and quality and may cost less than the original Product purchased and no charges or refunds will be made based on the replacement product or part cost difference; and
 - iv. is only applicable when the Product is used and operated in accordance with the Manufacturer's instructions.
6. What is not Covered by this Kleenmaid Warranty (excluded):-
 - a. any damage or failure to or of the Product or part of the Product:
 - i. due to the Product being inadequately serviced to manufacturer's recommendations;
 - ii. resulting from environmental conditions including and not limited to dirt, dust, rodents, insects, rust, corrosion, salt built-up, of or in any part of the Product;
 - iii. resulting from excessive use but fair wear and tear is excepted;
 - iv. resulting from poor installation including and not limited to positioning and externally fitted equipment such as plumbing and drainage, cabling, antennae or due to incompatibility of connected equipment;
 - v. caused by overheating as a result of sitting or positioning of the Product, where there is no provision for adequate ventilation or adequate protection from excessive dust;
 - vi. if the Product has been dismantled, repaired or serviced by any person other than someone authorised by Kleenmaid or its agents or representatives;
 - vii. caused by power surges or spikes, including and not limited to, mains power and telecommunications connections, or to other unspecified sources, incorrect power current, voltage fluctuation, amperage fluctuation, rust or corrosion;
 - viii. if the Product is dropped, collision of the Product with another object, use for which the Product is not designed, damage to the Product caused by your own negligence, accidental or deliberate misuse of the Product by you, theft, abuse, vandalism, flood, fire, earthquake, electrical storms or any other act of God or any war related events; or
 - ix. due to the introduction of abnormal heat loads to the Product;
 - b. costs of attendance and testing where no fault or defect covered by the terms of this Kleenmaid Warranty is identified in the Product;
 - c. initial setup and installation of the Product;
 - d. normal maintenance costs and costs incurred through the installation of items listed as requiring periodic replacement;
 - e. Products with removed or altered serial numbers;
 - f. consumables such as but not limited to bulbs/globes, glass, seals, filters, batteries and remote controls;
 - g. removal and reinstallation of an internal component not performed by an authorised Kleenmaid agent or representative or authorised service centre;

- h. cosmetic or structural items; or
 - i. any failures due to interference from or with other products and/or sources.
7. This Kleenmaid Warranty ceases if: -
- a. the Product ceases to carry the original manufacturer's serial number or is sold at an auction;
 - b. the Product is rented;
 - c. damage to the Product has occurred as listed in point 7a; or
 - d. there is failure to pay monies owing on invoices as a result of non-warranty work been carried out at the request of the end user as per point 16 below.
8. Neither Kleenmaid nor its representatives provide loan equipment under the terms of this Kleenmaid Warranty.
9. Any unauthorised access to the internal hardware of the Product will void this Kleenmaid Warranty.
10. Repair Notice: Products presented for repair may be replaced by refurbished Products of the same type rather than being repaired. Refurbished parts may be used to repair the Products.
11. Replacement items are "like for like" and is not "new for old" and does not indicate in any way that a faulty Product will be replaced with a new part or unit. "Like for like" may either be a quality checked, refurbished or reconditioned unit of the same or later batch of model/size/specifications
12. The cost of making a claim under this Kleenmaid Warranty is not covered by Kleenmaid, including any costs of transportation or travel expenses between your home and your nearest authorised service agent.
13. Kleenmaid accepts no liability for items that are lost, damaged, or stolen as a result of freight, transport or storage. If you are required to transport the Product to an authorised service centre, you must ensure that it is securely packed and insured.
14. On Public Holidays or other periods when regular business and wholesale operations are temporarily ceased, repairer availability and warranty response times may extend beyond the standard response times due to the unavailability of repairers and parts.
15. For any repair performed on a Product under this Kleenmaid Warranty where no fault can be found, or the item is deemed by Kleenmaid or an authorised agent, to be not faulty under this Kleenmaid Warranty, or the repair or fault is not covered under this Kleenmaid Warranty, a 'No Fault Found' fee is payable by you. Kleenmaid will advise you of this cost and seek your agreement to pay such costs before commencing such repairs.
16. Any repairs or services required that are outside the terms and conditions of this Kleenmaid Warranty can be carried out at your request at your cost (including where the Product has not been installed or set up correctly). Kleenmaid will always advise you of this cost and seek your agreement to pay such costs before commencing such repairs. A credit card may be required prior to the commencement of such services.
17. Extra charges will be payable by the customer should the Product not be readily accessible without special equipment, such as but not limited to cranes and lifts or should the Product be installed in a position that service access is blocked and/or repair work is not possible without uninstalling the Product to gain access.
18. You, the customer, may be entitled to purchase an extended warranty in respect of the Product. Any extended warranty will not be issued by Kleenmaid but by a third party. Any extended warranty services will be provided directly by the third party as principal and not as agent for Kleenmaid, under their extended warranty terms and conditions and not under this Kleenmaid Warranty.
19. To make a claim under this Kleenmaid Warranty, please have your proof of purchase and the serial number of the Product ready and call (02) 9310 1207 during business hours.
20. This Kleenmaid Warranty is given by:
- Name: Compass Capital Services Pty Ltd ABN 96 138 214 525 trading as Kleenmaid
Business address: Level 2, Suite 3, 204 Botany Rd, Alexandria NSW Australia 2015
Telephone: (02) 9310 1207
21. Definitions:
- a. **Australian Consumer Law** means the *Competition and Consumer Act 2010* (Cth).
 - b. **Domestic Use** means use of the Product for personal, domestic or household purposes.
 - c. **Kleenmaid** means Compass Capital Services Pty Ltd ABN 96 138 214 525 trading as Kleenmaid.
 - d. **Mainland Australia** means the following States and Territories of Australia: New South Wales, Victoria, South Australia, Western Australia, Queensland, Tasmania, Northern Territory, Australian Capital Territory.
 - e. **Product** means the appliance sold by Kleenmaid to you as evidenced by the original purchase invoice.
 - f. **Warranty Period** means the period of 36 months for domestic use, 12 months for non-domestic use or such alternative period as may be specified.

UPDATE NOTICE: This Kleenmaid Warranty is current as at 7 March 2017 but is subject to variation from time to time. For the latest version of the Kleenmaid Warranty, please see our website <http://www.kleenmaid-appliances.com.au/support/your-kleenmaid-warranty> or phone us on (02) 9310 1207.

Other products available in the Kleenmaid range of appliances

- | Washing machines
- | Clothes dryers
- | Dishwashers
- | Ovens
- | Cooktops
- | Steam ovens
- | Microwave ovens
- | Built in espresso
coffee machines
- | Rangehoods
- | Freestanding ovens

Compass Capital Services Pty Limited
trading as Kleenmaid
ABN 96138214525

Level 2, 204 Botany Road
Alexandria NSW 2015

E: support@kleenmaid.com.au
www.kleenmaid-appliances.com.au

